

267^A Estate of Tho: Holt 1^A 1^R 35² P F.192.193.100 Plan 174^F

- Application by Gilham Surveyor for Approval of Definition of Railway Bdy. 40. 868122.
- Inquiry by C. Sale re interests of Comar in residue of lot 30 (used for housing purposes) E.A. 30. 868501 RE.
- Def of Rly Bdy by Reg. Survey. Haig L. 54-885701 RE. F. 59490
- Appl. by Fetter Griffiths to purchase Rly land refused. Land needed for new Overbridge 56/868947 RE.
- Inquiry re resumption of land for proposed new Rail-bridge by R. Cluett 55/868647 RE.
- re. Half cost of kerbing & guttering £16-15-5 58/879701 RE.
- No objn. by Dept. to Shire Cncls. drainage plan. 56/594202 W & M.
- Re drainage of Subdivision off Mitchell Rd., Cncl. completes Agt (B.10251) 59-594310 W & M.
- Agreement with Council of the Shire of Sutherland re discharge of sullage waters into Rly drain A1962/4 Com. 62/594701 W & M.
- Definition of boundary approved 63/871725 RE. F11480
- Appl. to purchase - land to be leased. C. 64.594702.
- Enquiry by Mr. O.S. Kelly re location of prop. Georges Riv. Bridge - info. not known Com 63-536612 W & M.
- Appl. to purchase by Mr. K.P. Olsen - declined. C1. 871621 RE.
- No objection by Dept. to proposal by Ccl. re. drainage pipes under line 14^M. 0235^C 64594707 W & M.

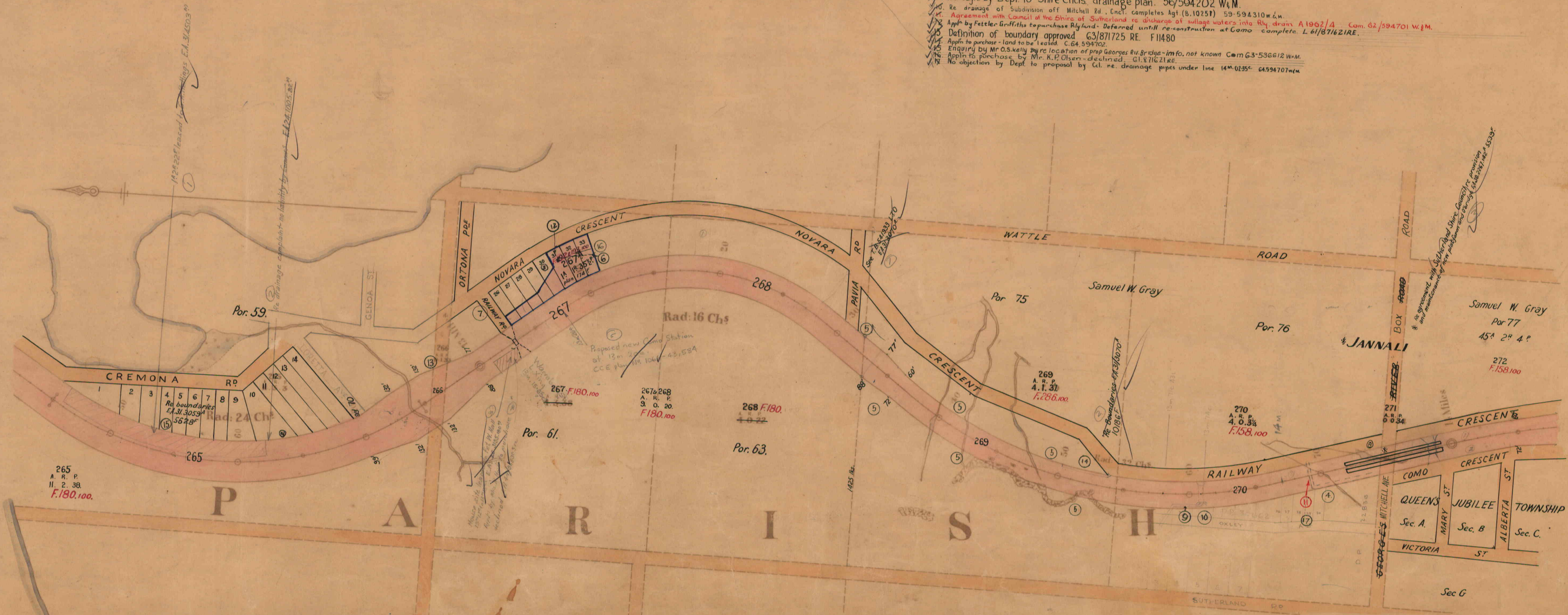

265
A. R. P.
11. 2. 38.
F. 180.100.

267
A. R. P.
15. 30. 21.
F. 180.100.

267 & 268
A. R. P.
39. 0. 20.
F. 180.100.

268
A. R. P.
1. 0. 32.
F. 180.

269
A. R. P.
4. 1. 37.
F. 286.100.

270
A. R. P.
4. 0. 34.
F. 158.100.

Samuel W. Gray
Por 77
45^A 2^R 4^P
272
F. 158.100.

COMO
QUEENS ST
MARY ST
JUBILEE ST
ALBERTA ST
TOWNSHIP
Sec. A
Sec. B
Sec. C.

102225^F leased to... E.A. 31/4503^F

re drainage complaint re liability by... F. 124.100.5.84^F

re agreement with Sutherland Shire Council re provision of... F. 108.230.142^F 4529^F

re boundaries of... F. 108.230.142^F

Proposed new G.M. Station at 13m 20m CCE plan 19. 1066-43,584